

1066.009 - DRBLUE 40/2/G32V A1BM5 NPTCB41U23NW0CX

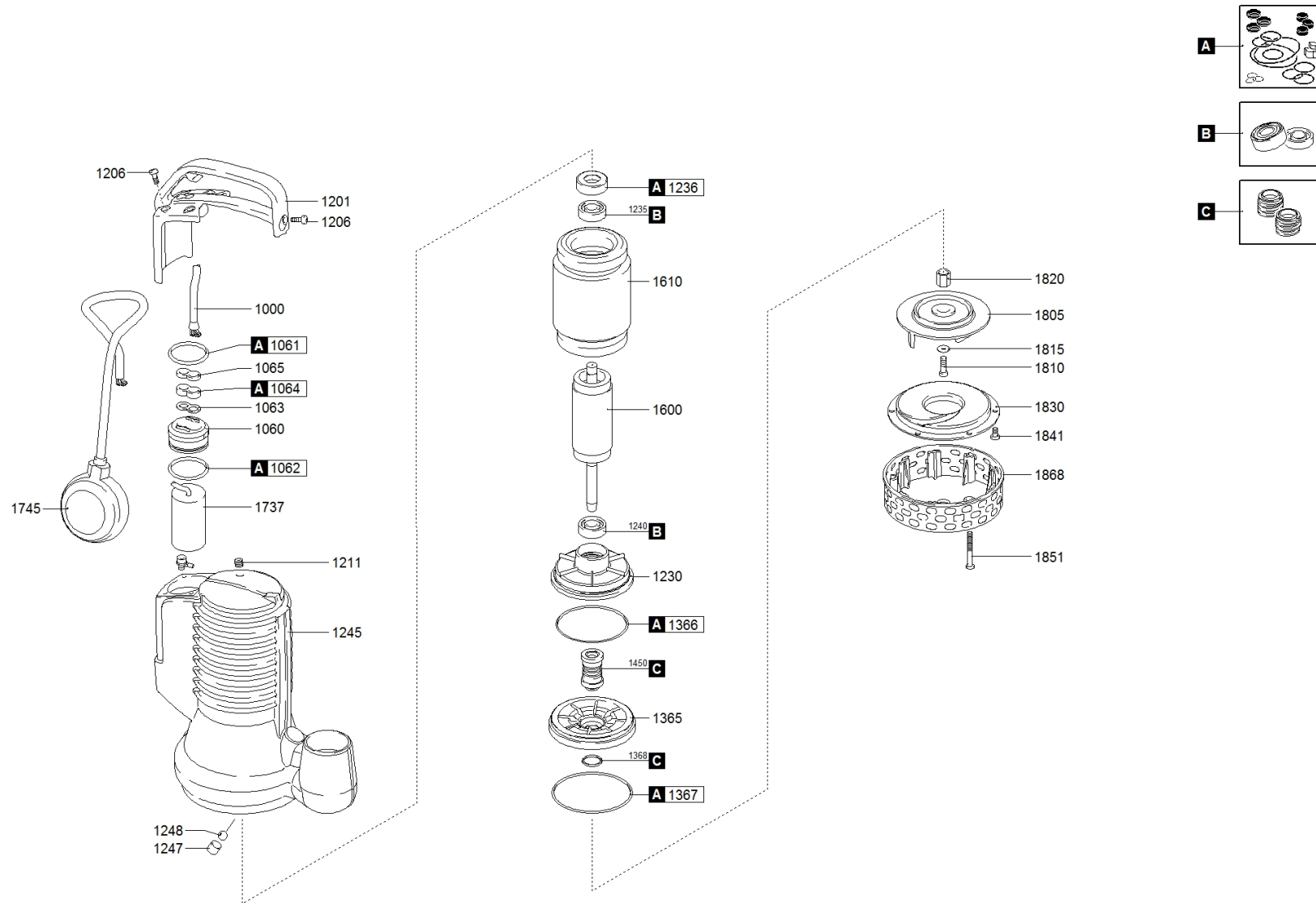



water solutions



1066.009 - DRBLUE 40/2/G32V A1BM5 NPTCB41U23NW0CX

	Code	Description		Q.ty	Price (€)
A	601008001	GASKETS KIT	801156	1	
C	602008011	MECHANICAL SEALS KIT	802762	1	
B	604008301	BEARINGS KIT		1	
1000	250102304010200000	POWER CABLE		1	
1060	239768026156	HOLDER [CABLE GLAND]	805885	1	
1061	271770412835300000	UPPER GASKET - HOLDER [CABLE GLAND]	711030	1	
1062	271770040952620000	LOWER GASKET - HOLDER [CABLE GLAND]		1	
1063	235467024279	CABLE STOP		1	
1063	2732001100000	CABLE STOP		1	
1064	235678024237	RUBBER GASKET	711018	1	
1065	235467024241	CABLE GLAND	805884	1	
1201	235360424137	CABLE GLAND HANDLE	804983	1	
1206	270830510140400000	SCREW [CABLE GLAND HANDLE >> COVER]		5	
1211	270139510104000000	CAP [TIGHTNESS TEST]	802099	1	
1230	230556223465	LOWER BEARING HOLDER		1	
1235	2729062010200000	UPPER BEARING	711365	1	
1236	238579023531	RUBBER PROTECTION [UPPER BEARING]		1	
1240	2729062010200000	LOWER BEARING	711365	1	
1245	231016224962	MOTOR CASE		1	
1365	2391000015023462	MECHANICAL SEAL FLANGE		1	
1366	271770088035000000	GASKET [LOWER BEARING HOLDER >> MECHANICAL SEAL FLANGE]		1	
1367	271770079018000000	GASKET [MECHANICAL SEAL FLANGE >> BASE]		1	
1368	237970100160600000	V-RING [MECHANICAL SEAL FLANGE]		1	
1450	230005060120000000	MECHANICAL SEAL		1	
1600	230233611023477	SHAFT WITH ROTOR		1	
1610	231101101001000000	WOUND STATOR	802372	1	
1737	2517004000000	CAPACITOR	711020	1	
1805	21416000580423795	IMPELLER	711286	1	
1810	270830510200400000	LOCKING IMPELLER	711026	1	
1815	270530202073000000	LOCKING WASHER [IMPELLER]		1	
1820	2307405623457	BUSH [IMPELLER]		1	
1830	2162311323458	SUCTION FLANGE	710980	1	
1841	270830510100400000	SCREW [SUCTION FLANGE >> MOTOR CASE]		3	
1851	270830510450400000	SCREW [STRAINER >> SUCTION FLANGE]		3	
1868	216563623890	CLOSED STRAINER	711284	1	

