

X3 Series

Inline Undersink Water Filter System with High Loop Designer Faucet

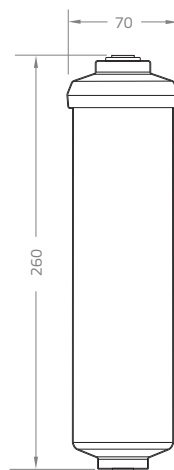

MAINS WATER



IL149Q

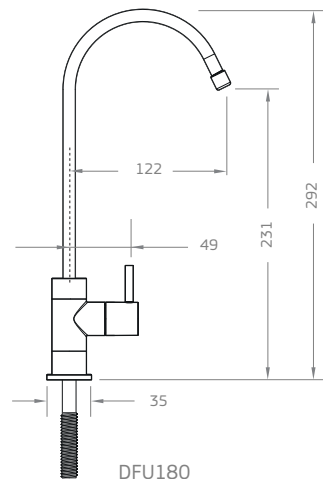

DFU180

Note: All dimensions are in mm.

Parts Included



Inline Filter Cartridge
IL149Q



High Loop Designer Faucet
DFU180



SmartTee™
KASV47



Mounting
Bracket



Multivalve
PVM45PH



User guide

Specifications

Ordering Code	Replacement Cartridge	Temp °C	Pressure kPa	Flow (Lpm)	Micron Rating (nominal)	Connection	Cartridge Size
X3	IL149Q	0-38	100-500	1.9	1	1/4" Quick Connect	10 1/4"

Notes:

X3 Series is an inline filter system with a slimline design that easily fits under your existing kitchen bench. All plumbing fittings are included for easy installation including a multifunction control valve for pressure reduction.

X3 Series incorporates the most advanced filtration technology. Designed to filter your mains and town water supply. It effectively reduces chlorine, sediment, bad taste, odours and heavy metals in water. It doesn't remove essential minerals or fluoride, leaving the water healthy and great tasting.

Can be mounted vertically or horizontally. Requires an approximate space of:

Vertical mounting: 350 (h) x 120 (w) mm

Horizontal mounting: 120 (h) x 350 (w) mm

All plumbing installation fittings included - no extras needed.

Required hole for the tap: 12.5mm diameter

Warranty:

Use only genuine Puretec replacement cartridges. 10 year warranty^ is 1 year parts and labour, 9 years parts only.



MAR 2024

For more information contact your local stockist or visit us at puretecgroupp.com

Australia **1300 140 140** | New Zealand **0800 130 140**

Note : 1. No claims can be made based on the specifications and images in this document. The design, technology, colours, features and prices are subject to change.
2. This document and all its contents are copyright protected. All rights are reserved, particularly alteration, translation and reproduction using electronic systems.
3. *Warranties in this document cover parts for the period stated and include cover for parts and labour for the first year where applicable, subject to approval. Excludes consumables.
Our Water Filtration Specialists can provide you with advice to suit your needs.



Puretec
PERFECTING WATER